

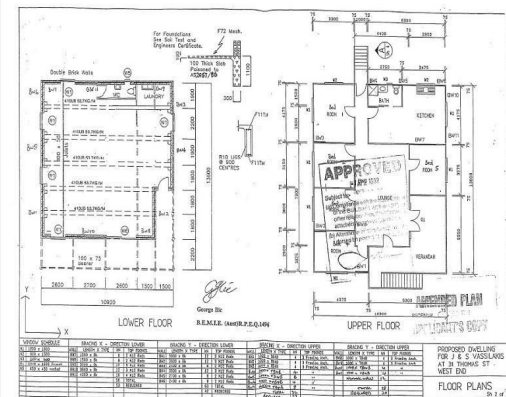

**firstnational**  
COMMERCIAL



31 Thomas Street, West End QLD 4101

## Central 2 Storey Office and Retail Opportunity

- Two street frontage
- 4 offices + large kitchen and open plan upstairs
- Open plan downstairs
- Fully air-conditioned
- One block to Boundary Street!
- Just available after last tenant stayed 17 years
- Whole building tenants only
- Excellent carparking
- Rates/Water - \$9000 per annum

Offices  
FOR LEASE

204sqm



**firstnational**  
COMMERCIAL

**George Koukides**

0412 872 786

georgek@metrofn.com.au