

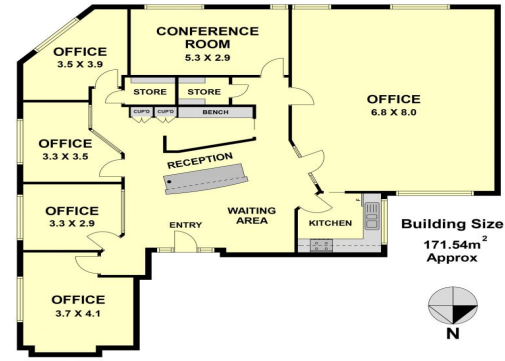

Boundary Indicative Only



Level 4 16a Bolton Street, Newcastle NSW 2300

Office Suite Right In the Middle of Town

Professional office suites in Historic Newcastle Building occupying a landmark location in the heart of Newcastle CBD

- Approximately 171sqm
- 4th floor location with modern elevator access

For Lease: \$41,000 + GST pa gross of outgoings

Offices
FOR LEASE

171sqm