

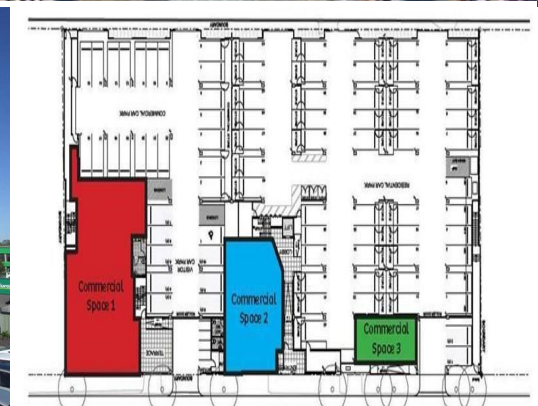

Architects Impression



(level 1) (lot 7) (s Throsby Street, Wickham NSW 2293)

NEW HARBOURSIDE OFFICE

Located just off major transport corridor - Hannell Street; on the edge of the Newcastle CBD, this mixed use building is currently under construction & offers:

- * First floor commercial office with disabled amenities
- * Options of 140, 188 or 330m²
- * B4 Mixed use zoning
- * 49 Residential apartments (100% already sold!!)
- * Due to be completed February 2015.

Don't miss this opportunity to be part of Newcastle's newest harbourside development.

Offices
FOR SALE

253sqm