

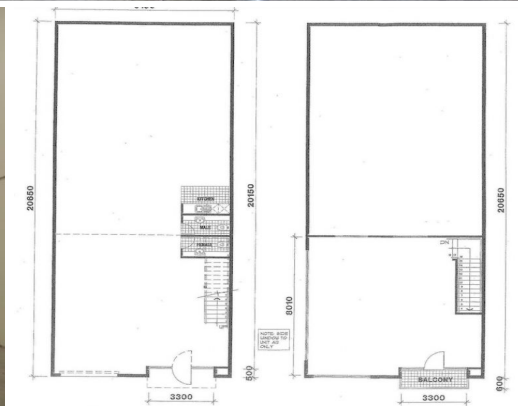

Outlines Indicative Only

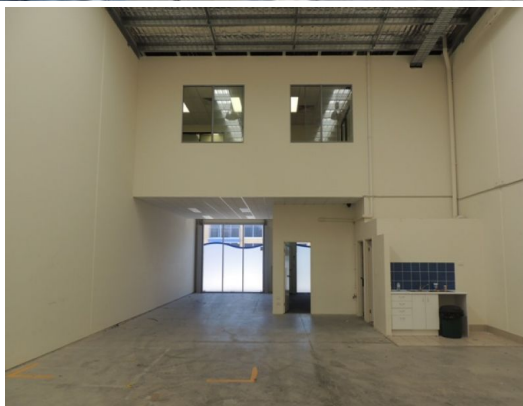

52/28 Burnside Road, Ormeau QLD 4208

Warehouse/Office in Prime Business Park

- * 185.10m²* floor area
- * 70.37m²* fitted out mezzanine office
- * Small fitted out reception area
- * Offices are air-conditioned and carpeted
- * 4 allocated car parks
- * Easy access to M1 Motorway
- * Call today to arrange your inspection

Industrial
FOR LEASE

255.47sqm

*approx

Please contact the listing agent for more details by clicking on the link above.

Ray White has not indep

Ray White®

Lisa Dunne

0420208891

l.dunne@rwsp.net