

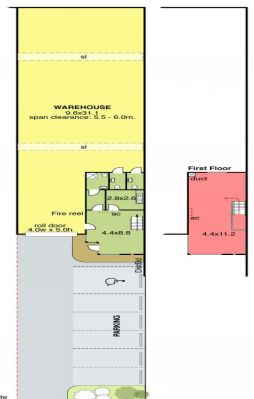

2 Hewer Avenue, Hampstead Gardens  
 Unit 4/2  
**ESTIMATED GROSS LETTABLE AREA**  
 Warehouse 271.9 sq. metres  
 Open Office/Amenity 50.9 sq. metres  
 FF Office 127.14 sq. metres  
**Total Gross L.A. 375.5 sq. metres**  
 Site (approx.) 542 sq. metres  
 Conforms with the PCA Method of Measurement  
 0  
 (Scale in metres) 10



## Unit 4/2 Hewer Street, Hampstead Gardens SA 5086

### Corporate Quality Office Warehouse

Light filled offices over two levels, on-site parking, security gates, high clearance warehousing and the list goes on.

Located on Hewer Street in Adelaide's commercial North East, metres from North East & Muller Roads.

Inspection is strictly by appointment only.

JLL  
 RLA 1842

Industrial  
 FOR LEASE

375sqm



**David Ludlow**

+61 439 260 645  
 David.Ludlow@ap.jll.com