

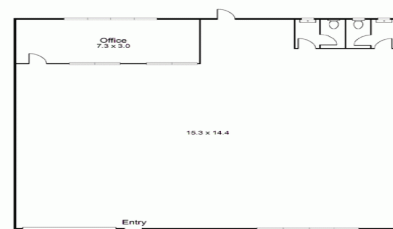

1/42 Burgess Road, BAYSWATER NORTH



ALL INFORMATION CONTAINED HEREIN IS GATHERED FROM SOURCES WE BELIEVE TO BE RELIABLE, HOWEVER WE CANNOT GUARANTEE

2/42 Burgess Road, Bayswater VIC 3153

Clean and Affordable

Ideal warehouse space situated just off Canterbury and Dorset Roads in a well kept industrial complex.

- ?? Area | 220 m2 approximately
- ?? Zoning | Industrial 1
- ?? Ample car parking
- ?? 3 phase power

Industrial
FOR LEASE

220sqm

Ray White®

Brett Diston

0439365532

brett.diston@raywhite.com

Kristian Etherington

0400 409 833

kristian.etherington@raywhite.com