

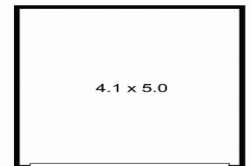

217/310 Lorimer Street, PORT MELBOURNE



ALL INFORMATION CONTAINED HEREIN IS GATHERED FROM SOURCES WE BELIEVE TO BE RELIABLE, HOWEVER WE CANNOT GUARANTEE

217/ 310 Lorimer Street, Port Melbourne VIC 3207

Need Storage space?

Look no further than this Modern Secure purpose built facility close to all amenities offering 20.5m2 approximately of storage with roller door access.

- ?? Secure facility
- ?? Central location
- ?? Lock up unit
- ?? Invest or occupy

Industrial
FOR SALE

20sqm

Ray White®

roland.rentz@raywhite.com

annalise.mastrangelo@raywhite.com