

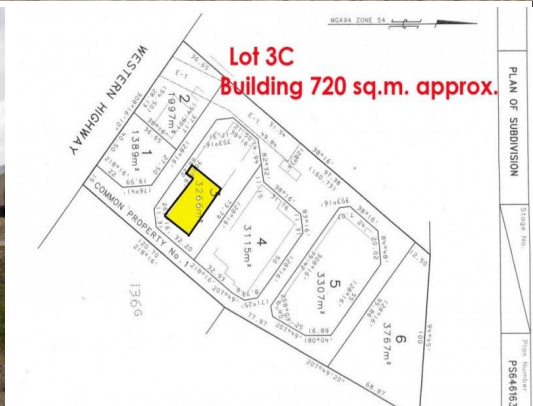

**first  
national**  
REAL ESTATE | Ararat



**3c/25-35 Horsham Rd, Stawell VIC 3380**

## Commercial Industrial Building - For Lease

Huge Commercial Industrial Building For Lease  
Large steel building around 720 sq.m approx  
Concrete slab floor  
High roller door access  
Property Frontage to busy Western Highway  
Ideal for light manufacturing, warehouse or works depot  
Enquire Now:

Retail  
FOR LEASE  
\$  
720sqm



**first  
national**  
REAL ESTATE | Ararat

**Phil Clark**

0417 509 025

[philip@fnararat.com.au](mailto:philip@fnararat.com.au)