

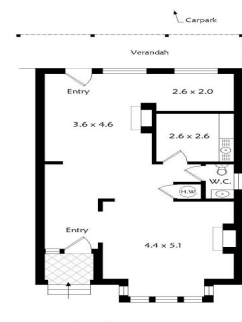

Salamanca
REALTY



4 Gregory Street, Sandy Bay.
Building area: 82 sq metres.



4 Gregory Street, Sandy Bay TAS 7005

Dual Street Shop Frontage

- Ground floor dual street shop frontage
- Excellent fit out
- Great exposure to foot traffic
- Retail/offices/medical consulting rooms

Vacant Possession

Retail
FOR LEASE

82sqm



Salamanca
REALTY

Alison Taylor

0448 044 739

a.taylor@salamancare.com.au