

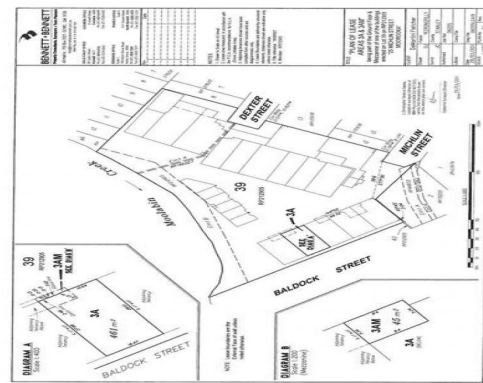

firstnational
COMMERCIAL



3/25 Michlin Street, Moorooka QLD 4105

Affordable @ Moorooka Industrial Village

This older style refurbished industrial complex is located in an ideal position and provides great storage/workspace for a variety of businesses. There is a snack food bar located in the complex along with ample parking and access for a pan-tech and other delivery vehicles.

The complex is situated off Ipswich Road in Moorookas Magic Mile approximately 8 radial kilometres south of the Brisbane CBD. Ipswich Road connects south onto the Ipswich motorway or provides access north to the CBD.

- 467 m2 plus Mezzanine of 45 m2
- Cafe on Site
- Refurbished Restrooms

Industrial
FOR LEASE

506sqm



firstnational
COMMERCIAL

Anthony Conias

0408 266 427

anthony.conias@metrofn.com.au