

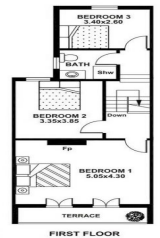

204 EDGECLIFF RD  
BONDI JUNCTION



FIRST FLOOR

## 204 Edgecliff Road, Woollahra NSW 2025

### Ideal Corner Live/Work Terrace

Properties of this nature rarely become available in the eastern suburbs.

This 125sqm (approx) terrace with parking will suite most professional consulting business with multiple offices over 2 floors, will also suite a work/ live arrangement.

Well located and of gorgeous character, the polished floorboards flow throughout the ground floor and great exposure on the corner of Edgecliff Road and Newland Street.

This gorgeous well presented commercial terrace will suit many uses subject to council approval.

Offices  
FOR LEASE

125sqm

**Sally-Anne McQuillan**

0400 203 203

sally@oxfordagency.com.au