

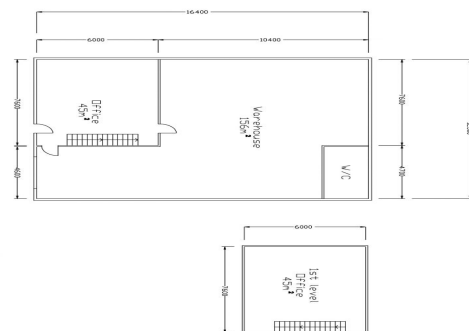

Bowen Street



24b Bowen Street, O'Connor



24b Bowen Street, O'Connor WA 6163

Office / Warehouse in O'Connor for Sale

Ray White Commercial (WA) is pleased to present this unique office/warehouse for sale in O'Connor. Unlike other office/warehouse properties, this unit has its own exclusive front yard/car park and cross over as indicated in the strata plan.

This property is one of 3 units in a Strata complex. Two units are fronting Bowen Street and one unit is fronting Parkinson Lane. The strata lot is a total of 434sqm which includes the building and the land. The unit has direct street access and does not share any yard/car park area with the other units.

- 226*sqm of front yard / car park area
- 156* sqm warehouse
- 90* sqm two level off

Industrial
FOR SALE

246sqm

Ray White.

Enrique Reyes

0421 888 688

enrique.reyes@raywhite.com