

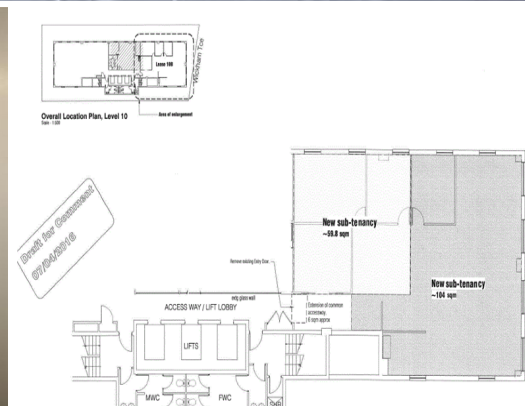

firstnational
COMMERCIAL



87 Wickham Terrace, Spring Hill QLD 4000

WICKHAM TCE NEW TENANCY

Right On Wickham Terrace from 49m² to 170m² available now on the 5th floor.

Located across the road from Central Station and with recently renovated foyer and lifts. "End Of trip" facilities with unisex showers and bike rack facilities.

Available now with your configuration and design and incentives.

- * Boutique Office Building
- * City Fringe.
- * Refurbished Foyer and Lift.

Offices
FOR LEASE
Contact Agent
104sqm



Anthony Conias

0408 266 427

anthony.conias@metrofn.com.au