

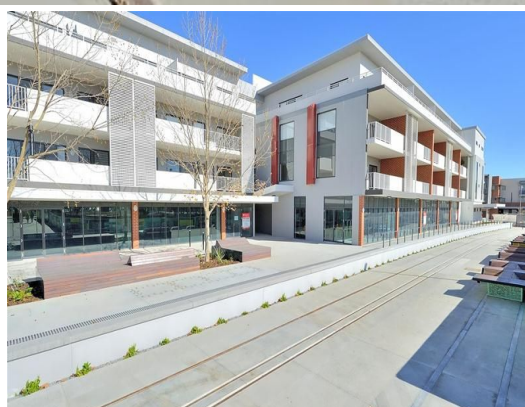

**firstnational**  
COMMERCIAL | Giles Jones



**Part 74 + 75/21 Foundry Road, Midland WA 6056**

## MODERN OFFICE - HISTORICAL AREA

Having recently reached completion, the Victoria Quarter apartments are the latest addition to the redevelopment area of the Midland Railway Workshops. Join the growing mix of tenants including restaurant, cafe/lunch bar and osteopath. This new commercial unit has been assigned for office use and is waiting for the right tenant to capitalise on this great opportunity. The space is connected with power & water, allocated underground parking space and has end of trip facilities available to staff.

126 square metres

Staff Amenities including end of trip facilities

Secure underground parking

This is a fantastic opp

Offices

FOR LEASE

195sqm



**firstnational**  
COMMERCIAL | Giles Jones

**Cambell Giles**

0418 936 544

[cambell.giles@gilesjones.com.au](mailto:cambell.giles@gilesjones.com.au)

[alex.taylor@gilesjones.com.au](mailto:alex.taylor@gilesjones.com.au)