

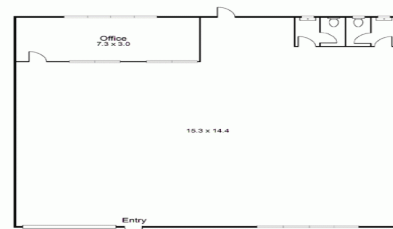

1/42 Burgess Road, BAYSWATER NORTH



ALL INFORMATION CONTAINED HEREIN IS GATHERED FROM SOURCES WE BELIEVE TO BE RELIABLE, HOWEVER WE CANNOT GUARANTEE

2/42 Burgess Road, Bayswater North VIC 3153

## Perfectly Located Warehouse

Ideal warehouse space situated just off Canterbury and Dorset Roads in a well kept industrial complex.

- Area | 220 m2 approximately
- Zoning | Industrial 1
- Ample car parking
- 3 phase power

Industrial  
FOR LEASE

220sqm

# Ray White®

**Kristian Etherington**

0400 409 833

kristian.etherington@raywhite.com