

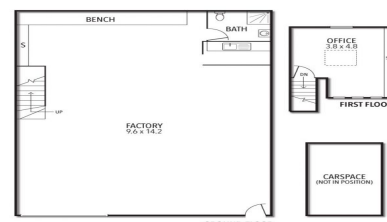

15/167 BEAVERS ROAD, NORTHCOTE



15/167 Beavers Road, Northcote VIC 3070

## Eclectic Appeal - Northcote Warehouse

\*\*\*OPEN FOR INSPECTION | Thursday 1st June from 1.00pm - 1.30pm

Retail  
FOR SALE

### Property Features

- Building Area | 155m2 approximately
- Car Parking | 1 allocated
- Zoning | Commercial 1
- Elevated Office
- Shower, Disabled Toilet, Kitchenette
- Light Bright Warehouse
- Electric Roller Door

155sqm

# Ray White®

**Brett Diston**

0439365532

brett.diston@raywhite.com