



**Kiosk 1/6 King Street, Warners Bay NSW 2282**

**Kiosk space in the Aldi anchored Shearwater development**

Perfectly positioned in Warners Bay's growing lakeside Commercial precinct, the new Shearwater development spans five stories offering a variety of mixed use space.

Anchored by Aldi Supermarket, there are 10 speciality shops and 2 kiosks all nestled directly below 113 residential apartments.

**Key attributes**

- 14m?\*
- Early access for fit out
- Use of loading dock facilities
- Conveniently located underground parking
- Kiosks situated at the King Street and Howard Street entrances

\*Approximately

For Lease: Price Upon Application

Retail  
 FOR LEASE  
 Price Upon Application  
 14sqm

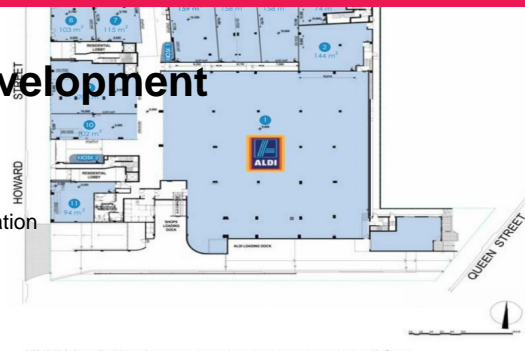

DISCLAIMER: Preliminary Plan Only. Any dimensions shown are approximate only and may vary during construction and final survey.