



Kiosk 2/6 King Street, Warners Bay NSW 2282

Kiosk space in the Aldi anchored Shearwater development

Perfectly positioned in Warners Bay's growing lakeside Commercial precinct, the new Shearwater development spans five stories offering a variety of mixed use space.

Anchored by Aldi Supermarket, there are 10 speciality shops and 2 kiosks all nestled directly below 113 residential apartments.

Key attributes

- 11m?*
- Early access for fit out
- Use of loading dock facilities
- Conveniently located underground parking
- Kiosks situated at the King Street and Howard Street entrances

*Approximately

For Lease: Price Upon Application

Retail
FOR LEASE
Price Upon Application
11sqm

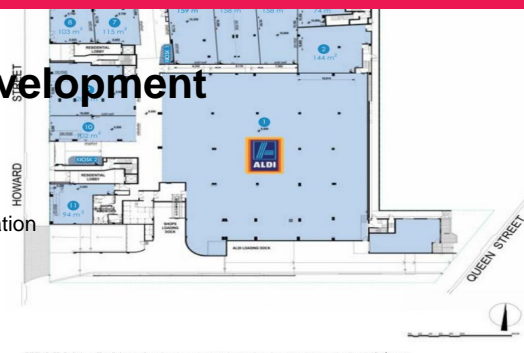

Ray White.

Lee Follington

0417443478

lee.follington@raywhite.com

John Parnham

0411474430

john.parnham@raywhite.com