



Shop 2+4/6 King Street, Warners Bay NSW 2282

King Street frontage in the new Shearwater development

Perfectly positioned in Warners Bay's growing lakeside Commercial precinct, the new Shearwater development spans five stories offering a variety of mixed use space.

Anchored by Aldi Supermarket, there are 10 speciality shops and 2 kiosks all nestled directly below 113 residential apartments.

With completion earmarked for late 2017, now is the time to inspect and secure your space.

Key attributes:

- 144m?*
- Suited to Retail, Commercial & Medical Uses
- Early access for fit out
- Use of loading dock facilities
- Conveniently located underground parking
- Flexible floor plan with the ability to combine areas to suit your business

*Approximately

For Lease: \$64,800 pa gross + GST

Retail
FOR LEASE

144sqm

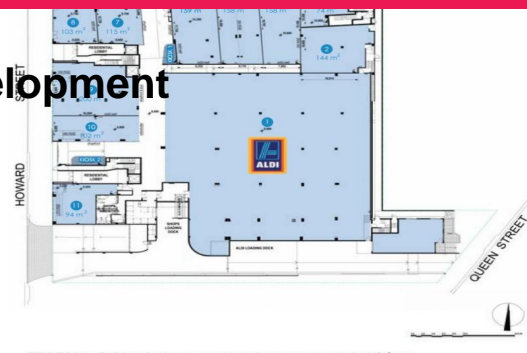

Ray White.

Lee Follington

0417443478

lee.follington@raywhite.com

John Parnham

0411474430

john.parnham@raywhite.com