



Shop 5/6 King Street, Warners Bay NSW 2282

Shearwater development - Commercial/Retail King Street frontage

Perfectly positioned in Warners Bay's growing lakeside Commercial precinct, the new Shearwater development spans five stories offering a variety of mixed use space.

Anchored by Aldi Supermarket, there are 10 speciality shops and 2 kiosks all nestled directly below 113 residential apartments.

With completion earmarked for late 2017, now is the time to inspect and secure your space.

Key attributes:

- 158m?*
- Early access for fit out
- Suited to Retail, Commercial & Medical Uses
- Use of loading dock facilities
- Conveniently located underground parking
- Flexible floor plan with the ability to combine areas to suit your business

*Approximately

For Lease: \$88,480 pa gross + GST

Retail
FOR LEASE

158sqm

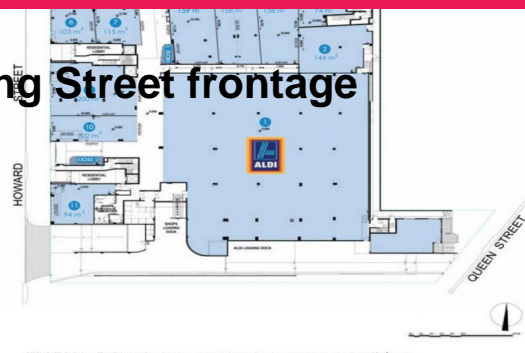

Ray White.

Lee Follington

0417443478

lee.follington@raywhite.com

John Parnham

0411474430

john.parnham@raywhite.com