



**Shop 8/6 King Street, Warners Bay NSW 2282**

## Shearwater development - Prime retail corner location

Perfectly positioned in Warners Bay's growing lakeside Commercial precinct, the new Shearwater development spans five stories offering a variety of mixed use space.

Anchored by Aldi Supermarket, there are 10 speciality shops and 2 kiosks all nestled directly below 113 residential apartments.

With completion earmarked for late 2017, now is the time to inspect and secure your space.

Key attributes:

- 103m?\*
- Early access for fit out
- Use of loading dock facilities
- Conveniently located underground parking
- Suited to Retail, Commercial & Medical Uses
- Flexible floor plan with the ability to combine areas to suit your business

\*Approx

FOR LEASE - Price Upon Application

Retail  
FOR LEASE

103sqm

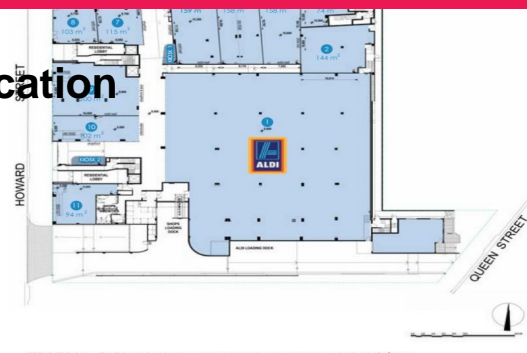

DISCLAIMER: Preliminary Plan Only. Any dimensions shown are approximate only and may vary during construction and final survey.

**Ray White.**

**Lee Follington**

0417443478

lee.follington@raywhite.com

**John Parnham**

0411474430

john.parnham@raywhite.com