

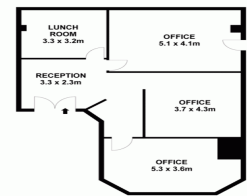

Kho & Lee
It's your move, we make it happen.™



101/330 Wattle Street, Ultimo
Detailed floor plans and the plan are intended as a guide only. They are not part of any legal document or offer and are subject to error, omission, and misreading and should not be used as reference. Sizes and measurements are approximate only. Interested parties should make their own enquiries.



101/330 Wattle Street, Ultimo NSW 2007

PRICE REDUCTION!!! FANTASTIC CITY FRINGE OFFICE, WITH EXCELLENT RETURNS!

Spacious 82sqm office suite situated in the ever growing Ultimo district minutes walk from central station, Broadway, Darling Harbour and Sydney CBD.

Currently leased at \$23,795 Incl. GST PA (lease end 31st August 2018 with annual rent increase at 4%). At over 6% return this is an excellent investment opportunity.

- 3 spacious office spaces, reception area & boardroom
- Strategically located adjacent to level 5 lift with dual access
- Choice of Halogen downlights or diffuser fluorescent panels
- Network cabling, A/C & alarm system
- Located in an IT, med

Offices
FOR SALE

82sqm

Kho & Lee

Kho & Lee Property

info@khoandlee.com.au
Group