



Ray White



Ray White



Ray White

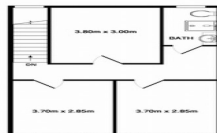
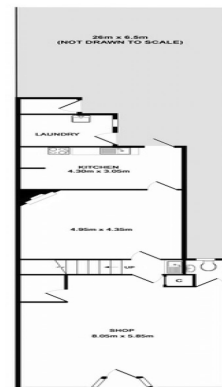

294 Waverley Rd, Malvern East VIC 3145

RETAIL/OFFICE WITH DWELLING IN MALVERN EAST

This high exposure property being superbly located on Waverley Road, Malvern East. This 3 x bedroom property has just been renovated also offering large parcel of available land on the rear for ample parking or any other suitable use.

- Total building area over two levels 130m² approx
- Including open plan retail area of 50m² approx
- Three bedrooms
- Large shop front
- Rear access
- Ample on-site parking
- Commercial 1 zoning

\$38,000 p/a + GST + Out

Retail
FOR LEASE

130sqm

Ray White

Paul Rizzo

0418 688 888

paul.rizzo@raywhite.com

Joshua Colosimo

0413 790 309

joshua.colosimo@raywhite.com