

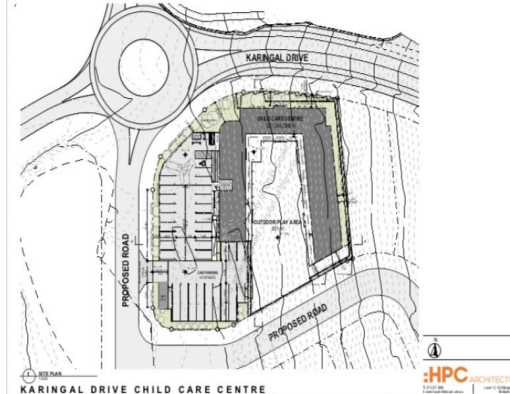

**Proposed Staging Plan
1 into 17 lots in 2 stages
Cancelling Lot 20 on RP152380
30 Karingal Drive PIMPAMA**

HPC
urban design + planning
urban design + planning

hpc urban design + planning pty ltd
and business, urban planning, project management,
development advice
t: 5217 0800 f: 5 5267 0885 w: www.hpcurban.com.au



30 Karingal Drive, Pimpama QLD 4209

PRIME RE-DEVELOPMENT SITE - DA APPROVED FOR 122 PLACE CHILDCARE CENTRE PLUS 16 R

DA APPROVED FOR 122 PLACE CHILDCARE CENTRE PLUS 16 RESIDENTIAL LOTS.

Childcare Centre consists of 8 classrooms, reception, lobby, kitchen, staff room, accounts room, store room, bathroom facilities, covered area 778m²*, outdoor area 871m²* and 40 carparks.

- Total land area 2.69ha*
- Childcare Centre area allocation 3484m²*
- 16 residential lots from 453m²* to 1528m²
- * Approximately

Land
FOR SALE
3,100,000

Ray White

The Runaway Bay Group

Ali Mian

0415 521 721

ali.mian@raywhite.com

Anna Tang

0468 734 939

anna.tang@raywhite.com