

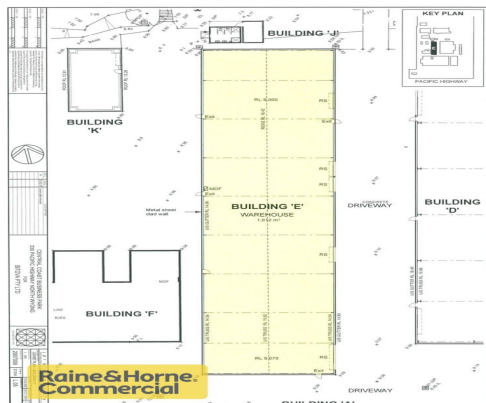

Raine&Horne.
Commercial



Unit E / 4 Dulmison Avenue, Wyong NSW 2259

Freestanding Industrial one of the hottest addresses in town

Looking for a large industrial warehouse that is easy to work with, accessible, and part of a good, stable industrial complex? This may be the property you need.

- 1,012m²*
- Five roller door access points
- Extremely competitive rental
- Right in the middle of all the new developments coming to North Wyong, including the ING 4 Storey Tower.

Well worth your time to inspect.

For more information or

Industrial

FOR LEASE

Price on Application

1012sqm

Raine&Horne.
Commercial

Brad Rogers

0459 921 122

brad@rhccc.com.au