

1/25 PERCY STREET, HEIDELBERG WEST

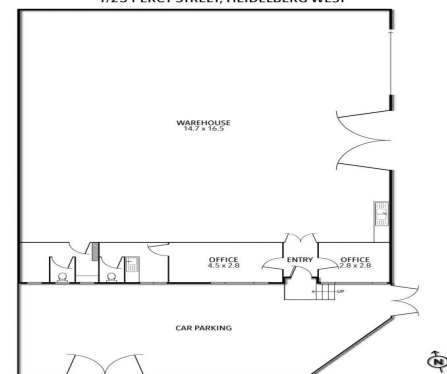

1/25 Percy Street, Heidelberg West VIC 3081

Classic Heritage Charm

This corner positioned warehouse offers a unique prospect for those seeking stylish space in a tightly held industrial precinct in one of Melbourne's rapidly growing suburbs. The property offers great natural light, onsite car parking and dual roller doors, making it a rare opportunity not to be missed.

- Building area | 295m² approximately
- Office, kitchenette & toilet amenities
- Zoning | Industrial 1

Industrial
FOR LEASE

295sqm

Ray White®

Kristian Etherington

0400 409 833

kristian.etherington@raywhite.com