

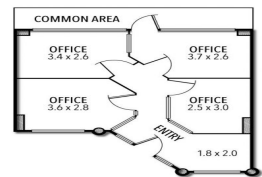

612/566 ST KILDA ROAD, MELBOURNE



612/566 St Kilda Road, Melbourne VIC 3004

## Superb Accessibility And Flexibility For Sale Or Lease

FOR SALE OR FOR LEASE. Invest or occupy in the heart of Melbourne without the CBD price tag! Located on the sixth floor of the iconic Jewel development, the property is approximately 60m<sup>2</sup> in size, featuring four partitioned office areas plus reception. Title includes three space tandem parking bay within secure onsite parking area. The building also offers an onsite cafe and gift shop, as well as 24 hour access to ensure maximum accessibility and flexibility.

- Flexible leasing terms
- Rental inclusive of outgoings
- Zoning | Commercial 1
- Building area | 60m<sup>2</sup> approximately

Offices  
FOR LEASE

60sqm

# Ray White®

**Cameron Barber**

0431 176 786

cameron.barber@raywhite.com