

**Suite 7.01**

NLA: 123 m<sup>2</sup>

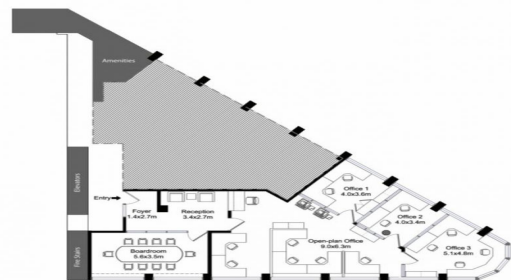

**Suite 7.01/62 Pitt Street, Sydney NSW 2000**

**62 Pitt Street**

62 Pitt Street is located in the heart of the financial core on the corner of Spring and Pitt Streets adjacent to Australia Square. The building features a bright modern foyer, two high-quality lifts, brand new showers and changing facilities.

Leased by: Ronayne Owens Lawyers  
Area: 122.9 sqm  
Rental: \$985 gross per sqm  
Start date: May 2018  
Term: 1 year  
Incentive: Contact Agent

Offices  
FOR LEASE

123sqm

**Ray White**

**Naomi Vilar**

[nvilar@raywhite.com](mailto:nvilar@raywhite.com)