

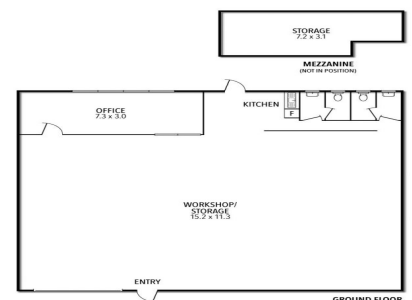

2/42 BURGESS ROAD, BAYSWATER NORTH



2/42 Burgess Road, Bayswater North VIC 3153

Centrally Located Warehouse

Neat warehouse space centrally located in one of the Eastern suburbs major industrial precincts. An ideal place to grow your business, with handy office space, amenities, and mezzanine storage. Three (3) Phase Power, Industrial 1 zoning, and ample car parking equals maximum flexibility for your use.

- Building area | 216m² approximately
- Zoning | Industrial 1
- Three (3) Phase Power

Industrial
FOR LEASE

216sqm

Ray White®

Cameron Barber

0431 176 786

cameron.barber@raywhite.com