

632 QUEENSBERRY STREET, NORTH MELBOURNE

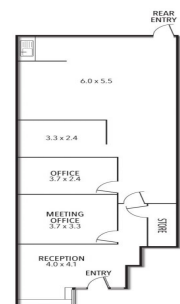

632 Queensberry Street, North Melbourne VIC 3051

Affordable City Fringe Office

This ground floor office/retail space is the perfect premises suitable to a range of businesses (STCA). These premises locate itself in a trendy pocket amidst a growing precinct at the doorstep of the Melbourne CBD.

- Building area | 103m2 approximately
- Off street car space at rear
- Flexible lease terms

Retail
FOR LEASE

103sqm

Ray White®

Kristian Etherington **Brett Diston**

0400 409 833

kristian.etherington@raywhite.com

0439365532

brett.diston@raywhite.com