

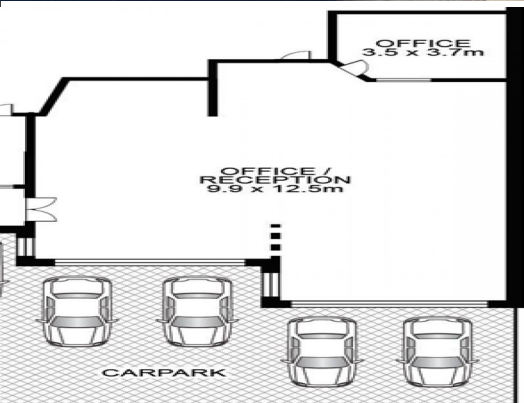

**firstnational**  
COMMERCIAL



**2a/314 Montague Road, West End QLD 4101**

## **Ideal Showroom / Office**

- Blank canvas suits multiple uses
- Transport at door
- 2 car spaces

Situated directly across the road from the "Light and Co" building is this 1st level premises with huge frontage and exposure right onto Montague Road that captures passing traffic. Ideal for showroom, office or retail. 2 car parks available.

Retail  
FOR LEASE

125sqm



**firstnational**  
COMMERCIAL

**Anthony Conias**

0408 266 427

[anthony.conias@metrofn.com.au](mailto:anthony.conias@metrofn.com.au)