

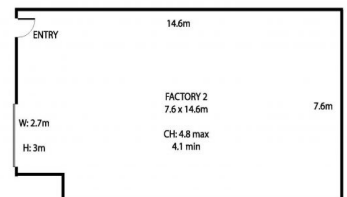

FACTORY 2/ 15-17 West Street, Brookvale



APPROX TOTAL: 109m²

2/15-17 West Street, Brookvale NSW 2100

EASY ACCESS WAREHOUSE SPACE IN PRIME BROOKVALE LOCATION

SEE IT TODAY, TONIGHT, TOMORROW, ANYTIME YOU LIKE? CALL US, WE NEVER SLEEP :)

- | Warehouse size 109m² approx.
- | Solid construction
- | Roller Door Access
- | Ceiling height from 4.1m - 4.8m
- | Roller door 2.7m (w) x 3m (h)
- | Office & separate waiting area
- | Kitchenette & plenty of power points
- | Mezzanine area for extra storage
- | Skylight runs the len

Industrial
FOR LEASE

109sqm



James Lamplough

0477 772 435

novak@mail.inspectrealestate.com.au

Nathan Araya

0402 964 724

novak@mail.inspectrealestate.com.au