

G10/146 BELL STREET, COBURG

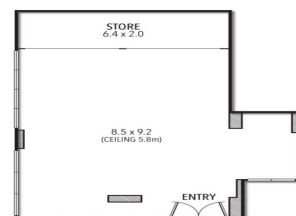

**G10/146 Bell Street, Coburg VIC 3058**

## Make An Offer

Here's your ideal chance to secure a lease in a property allowing for the flexibility your business requires to thrive. The property locates itself with immense exposure to one of Melbourne's busiest roads with walking distance to Coburg train station for convenience of staff and clientele. With an affordable rental on offer and brand new construction this is an opportunity which will simply not last long.

- Building area | 82m<sup>2</sup> approximately
- Onsite car parking
- Flexible lease terms
- Suitable to a range of uses (STCA)
- Potential to build mezzanine (STCA)

Retail  
FOR LEASE

82sqm

# Ray White®

**Kristian Etherington**

0400 409 833

kristian.etherington@raywhite.com