



**Raine&Horne.  
Commercial**



**Raine&Horne.  
Commercial**



**Raine&Horne.  
Commercial**

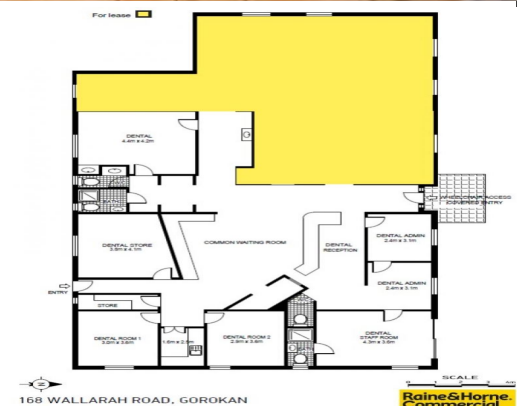

168 WALLARAH ROAD, GOROKAN

**Raine&Horne.  
Commercial**

## 168b Wallarah Rd, Gorokan NSW 2263

### Affordable Medical grade premises available now!

If you're looking for a medical grade premises with great exposure, ground level with parking on site, this property is for you! The premises is part of the whole building with the other area occupied by a Dentist.

Features include

- Multiple rooms with coped flooring
- Air conditioned
- Water & waste in each room
- Wheelchair friendly
- Plenty of parking on site
- Great exposure to Wallarah Rd

Healthcare

FOR LEASE

\$28,600 pa net + GST

130sqm

**Raine&Horne.  
Commercial**

**Ben Purdue**

0450 719 600

ben@rhccc.com.au