



**34/49-51 Mitchell Road, Brookvale NSW 2100**

## 3 OFFICE ROOMS READY FOR WORKING

- | NLA: 84sqm
- | 3 separated rooms with flexible floor plan
- | Security access into building
- | Toilet amenities available
- | Sun Drenched working spaces
- | 3 car spaces for tenants
- | Shared kitchen facility
- | Plenty of power points - plugin and play!
- | Join a bustling hub of businesses in tightly held Brookvale
- | Air conditioning system throughout
- | Ample storage for all
- | Great for entry level businesses and experienced alike
- | More options available 12sqm/37sqm/84sqm

Offices  
FOR LEASE

84sqm

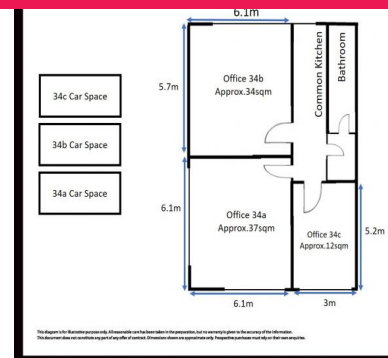

**NOVAK**  
PROPERTIES