

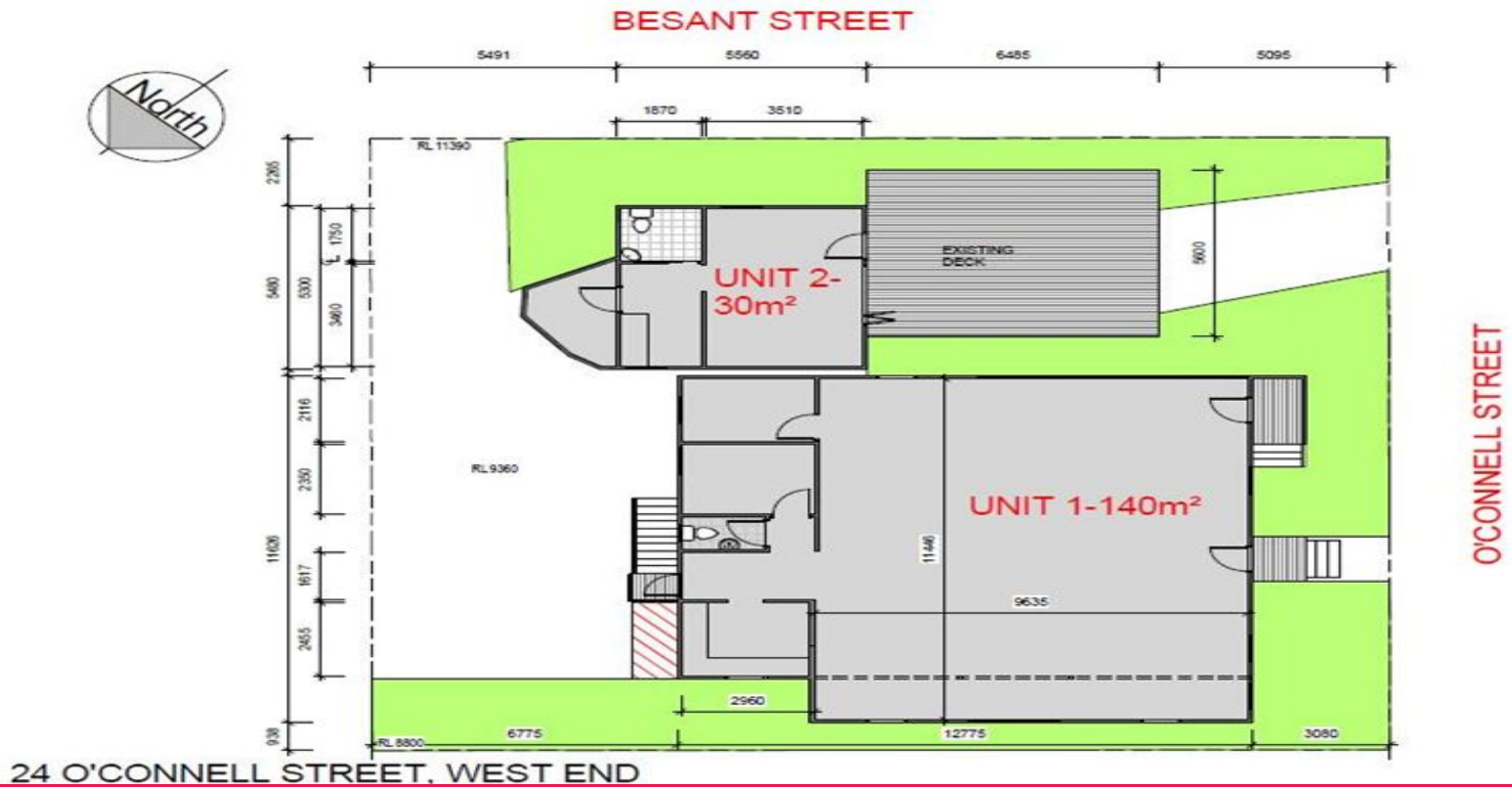

firstnational
COMMERCIAL



2/24 O'connell Street, West End QLD 4101

West End Coffee/Cafe

- Handy Location with Exposure
- Walk Southbank / BSHS.

Positioned right on a busy corner is this unique little 30m2 internal + outdoor area tenancy ideal for a coffee/cafe operator looking for a different location. Get amongst this little pocket just behind Boundary Street that is being transformed into commercial offerings.

Contact Anthony Conias for further information.

Retail
FOR LEASE
Contact Agent
30sqm



firstnational
COMMERCIAL

Anthony Conias

0408 266 427

anthony.conias@metrofn.com.au