

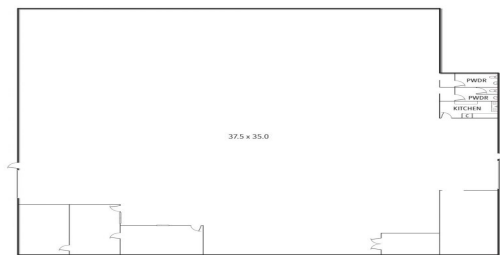

3/8-12 SIMLA STREET, MITCHAM



3/8-12 Simla Street, Mitcham VIC 3132

Simple & Sensational Simla Street Warehouse

This rare larger scale Whitehorse Industrial opportunity speaks for itself. Immaculately well kept, and superbly located within walking distance to the recently upgraded Mitcham Station, the property makes use of a low traffic street accompanied by dual roller doors for ease of accessibility. Featuring immaculately well kept office amenities for staff and ample onsite car parking, this is a unique opportunity which will not last long.

- Building area | 1,275m² approximately
- Dual roller door accessibility
- Office & toilet amenities
- 3 phase power

Industrial
FOR LEASE

1275sqm

Ray White®

Kristian Etherington

0400 409 833

kristian.etherington@raywhite.com