

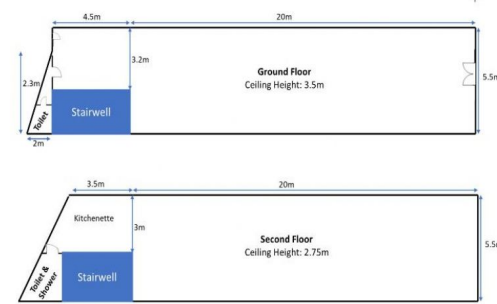

677 Pittwater Road, Dee Why, NSW 2099



677 Pittwater Road, Dee Why NSW 2099

MAIN ROAD OPPORTUNITY | WHOLE BUILDING AVAILABLE

- | Ground floor 130sqm | First floor 130sqm
- | Dimensions | 6.5M x 20M
- | Full 5.5m glass sliding door
- | Dual storey advertising potential
- | Show off at the mouth of Oaks Ave and Pittwater Rd
- | Column-less structure with great flexibility
- | Grand ceilings for great atmosphere
- | Kitchenette and shower all on one floor
- | Internal amenities on both levels
- | High traffic area with plenty of passerby
- | Rear lane access perfect for deliveries
- | Abundance of natural light and plenty of LED lighting
- | Free standing building - no strata!
- | Grease trap & exhaust

Retail
FOR LEASE

260sqm

Mark Novak

0421111111

novak@mail.inspectrealestate.com.au