

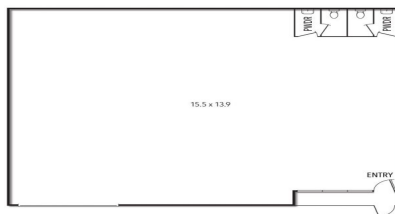

4/31 RUSHDALE STREET, KNOXFIELD



4/31 Rushdale Street, Knoxfield VIC 3180

## Entry Level Warehouses with Superior Access

Entry level warehouse available immediately. Offered with flexible terms, this property offers superior access to the Eastern suburb's major arterials along with space that newer developments simply cannot offer. Open floorplan equals maximum flexibility. Situated within Knox City Council's Industrial 1 Zone, suitable for a variety of uses (STCA).

- Flexible leasing terms
- Building area | 217m<sup>2</sup> approximately

Industrial  
FOR LEASE

217sqm

# Ray White®

**Cameron Barber**

0431 176 786

cameron.barber@raywhite.com