

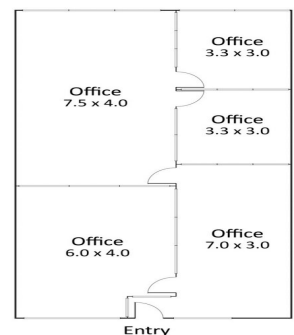

41E/190-200 Jells Road, Wheelers Hill



Disclaimer: Whilst we believe the contents of this document to be accurate, we suggest the prospective purchasers make their own enquiries.

41e/190 Jells Road, Wheelers Hill VIC 3150

First Floor Office in Wheelers Hill

- First floor office suite of 96m2 approx.
- Comprising glass partitioned office with reception area, boardroom, two private offices and open plan area
- Heating / cooling and shared amenities
- Two allocated car spaces plus ample customer parking
- Located in a corporate environment adjoining Wheelers Hill Shopping Centre
- Excellent location with easy access to Monash and Eastlink Freeways.

\$26,000 per annum + Outgoings + GST

Ryan Amler 0401 971 622
Joshua Colosimo 0413 79

Offices
FOR LEASE

96sqm

Ray White

Ryan Amler
0401971622
ryan.amler@raywhite.com