

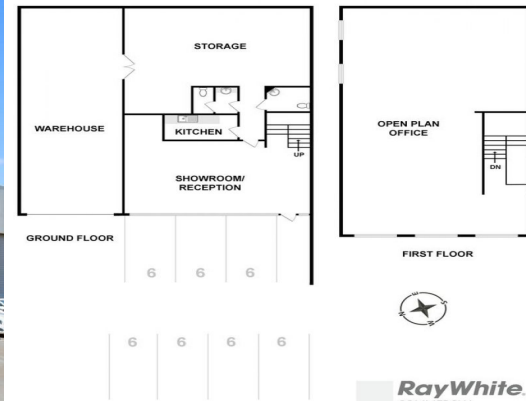

RayWhite
COMMERCIAL



6/20 Duerdin Street, Clayton VIC 3168

Quality Corporate Office / Showroom with 7m Warehouse Clearance!

This office / warehouse located within Monash Corporate Centre with onsite cafe and gymnasium amenities is positioned within a high profile business park and in close proximity to major arterial roadways such as the Monash Freeway (1.3kms*), Ferntree Gully Road, Blackburn Road, Wellington Road and Princes Highway.

The property is surrounded by an abundance of quality tenants including: Monash University, Monash Medical Centre and CSIRO and Telstra GOC.

Inspection will Impress!

Industrial
FOR LEASE

390sqm

Ray White

Theo Karkanis

0431391035

theo.karkanis@raywhite.com