

611/1 QUEENS ROAD, MELBOURNE

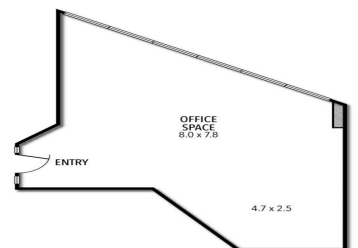

611/1 Queens Road, Melbourne VIC 3004

Must Be Leased - Rental Incentives Available

- Building area | 50m² approximately
- Abundant natural light
- Onsite car parking
- Professional facilities available

Offices
FOR LEASE

50sqm

Ray White®

Kristian Etherington **Brett Diston**

0400 409 833

0439365532

kristian.etherington@raywhite.com

brett.diston@raywhite.com