

820/1 QUEENS ROAD, MELBOURNE

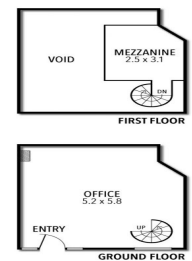

820/1 Queens Road, Melbourne VIC 3004

## Magnificent Melbourne Mezzanine Office Suite

When it comes to value for money, it is impossible for any other offering to compete with 1 Queens Road as a vibrant business hub offering professional services, a modern work place for staff and clientele to visit, and a prestigious city address, all at an affordable price. This suite is superbly well kept, the perfect entry level office space for any start up or those looking to downsize.

- Building area | 37m<sup>2</sup> approximately
- Mezzanine office/storage space
- Onsite car parking
- Professional facilities available

Offices  
FOR LEASE

37sqm

# Ray White®

**Kristian Etherington**

0400 409 833

kristian.etherington@raywhite.com