

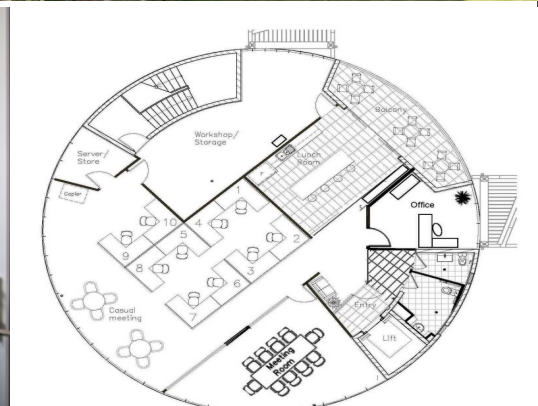

Outline Indicative Only



8/270 Lahrs Road, Ormeau QLD 4208

Modern Corporate Commercial Office

Be part of this iconic building and benefit from all the advantages being offered in this newly redeveloped business precinct. Offering exceptional corporate offices now is the time to inspect 270 Lahrs Road, Ormeau.

- * Modern corporate office 264m*
- * Fitted out office with open plan and boardroom
- * Deck over landscaped courtyard
- * Additional highway signage opportunity
- * Optical fibre available and NBN available
- * CCTV and electronic door access
- * 10 allocated car parking spaces
- * Coffee shop on site

Please contact the list

Offices
FOR LEASE

264sqm

Ray White®

Lisa Dunne

0420208891

l.dunne@rwsp.net