

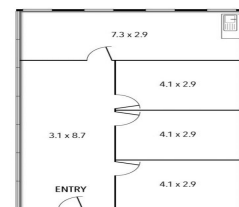

12/385 BELMORE ROAD, BALWYN



12/385 Belmore Road, Balwyn VIC 3103

Blissful Balwyn Office Suite

This simple, well kept premises provides an opportunity for those seeking affordability in one of Melbourne's most prestigious locales. Offering consulting rooms for staff and clientele, flexible open plan areas, and a corner location, this is a rare chance you simply cannot afford to overlook.

- Building area | 83m2 approximately
- Partitioned offices
- Abundant natural light
- 2 secure car spaces

Offices
FOR SALE

83sqm

Ray White®

Kristian Etherington **Brett Diston**

0400 409 833

kristian.etherington@raywhite.com

0439365532

brett.diston@raywhite.com