

362-366 SYDNEY ROAD, BRUNSWICK

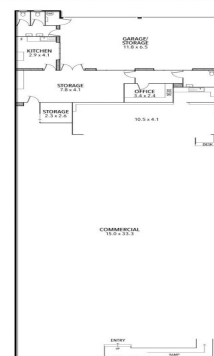

**362-366 Sydney Road, Brunswick VIC 3056**

## All Offers Considered

This widely fronted premises provides immense retail exposure and a large open plan layout, giving a plethora of options for the shrewd business owner. Offering walking distance to Brunswick Station, tram accessibility, and ample parking for staff, this is a truly unique opportunity you simply cannot afford to overlook.

- ? Building area | 655m2 approximately
- ? Undercover rear car parking
- ? Zoning | Commercial 1
- ? Suitable to many uses (STCA)

Please contact for a Private Inspection.

Retail  
FOR LEASE

655sqm

# Ray White®

**Brett Diston**

0439365532

brett.diston@raywhite.com