

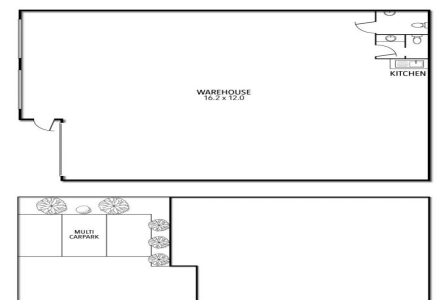

1/6-8 EASTSPUR COURT, KILSYTH



1/6-8 Eastspur Court, Kilsyth VIC 3137

Unit 1 & Unit 2 SOLD at Auction | Outstanding Results

Unit 1 sold 14.6% above reserve
Unit 2 sold 11.5% above reserve

Industrial
FOR SALE

- Building area | 186m² approximately each
- Unit 1 | Vacant possession
- Unit 2 | Returning \$20,400 pa net
- Zoning | Industrial 1

186sqm

Ray White®

Kristian Etherington **Brett Diston**

0400 409 833

0439365532

kristian.etherington@raywhite.com

brett.diston@raywhite.com