

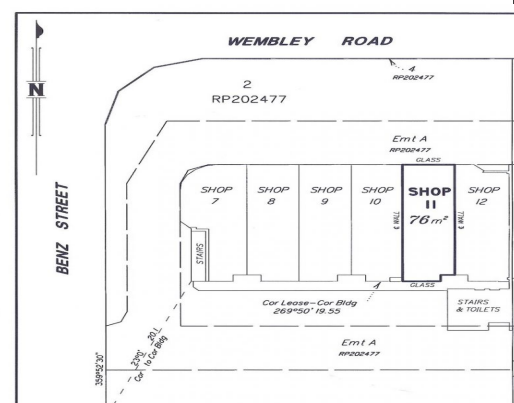

Outlines Indicative Only



11/84 Wembley Road, Logan Central QLD 4114

Calling All Professional Office Users

- * 76m²* Professional office suite
- * Would suit professional office users such as accountants, solicitors etc
- * Includes reception/open plan area & 2 individual offices
- * Offers excellent exposure and signage opportunities to Wembley Road
- * Ducted air-conditioning throughout
- * Ample on-site parking
- * Shared amenities
- * In close proximity to public transport and Woodridge Train Station
- * Adjacent to Logan Central Plaza
- * Pylon signage available
- * Easily accessible from M1 & Gateway Motorways and major arterial roads

Please contact the list

Offices
FOR LEASE
\$22,500 Gross PA + GST
76sqm

Ray White®

Lisa Dunne
0420208891
l.dunne@rwsp.net