

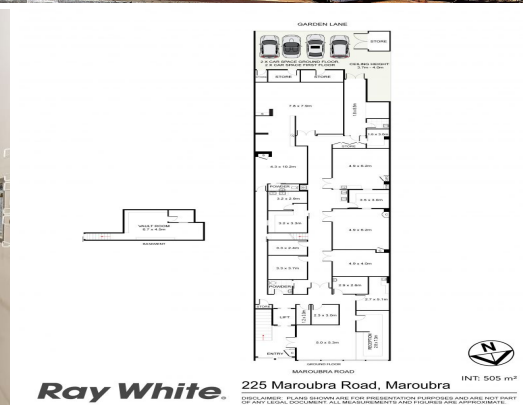

Southeast Sydney Veterinary Hospital



Ground Floor/225 Maroubra Road, Maroubra NSW 2035

Ground Floor Veterinary Hospital in the Heart of Maroubra Junction

In a prime position fronting Maroubra Road, this whole floor veterinary hospital offers a rare opportunity. Ideal for a vet or other medical business, the premises is fully fitted out and ready to occupy. With valuable laneway access at the rear, it features a parking bay for up to two cars plus easy access to street parking. With a Chemist Warehouse next door, the premises is located just metres from the bustling Pacific Square precinct.

Retail
FOR LEASE

505sqm

- 505sqm* whole floor medical premises
- Comprising multiple consultation/theatre rooms
- Front reception, waiting area, bathroom facilities
- Rear laneway access
- Shared entry lobby, easy ground level accessibility

Ray White

Alex Santelli

0403104146

a.santelli@rwccs.com