

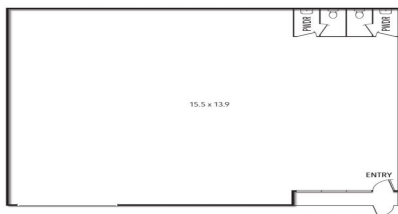

4/31 RUSHDALE STREET, KNOXFIELD



5/31 Rushdale Street, Knoxfield VIC 3180

Great Entry Level Warehouse

Get a head start in this versatile entry level warehouse. Offered with flexible terms, this property offers great access to the Eastern suburb's major arterials along with space that newer developments simply cannot match. Open floor plan equals maximum flexibility. Zoned Industrial 1 and suitable for a variety of uses (STCA).

- Flexible leasing terms
- Building area | 214m² approximately
- Zoning | Industrial 1

Industrial
FOR LEASE

214sqm

Ray White®

Cameron Barber

0431 176 786

cameron.barber@raywhite.com